

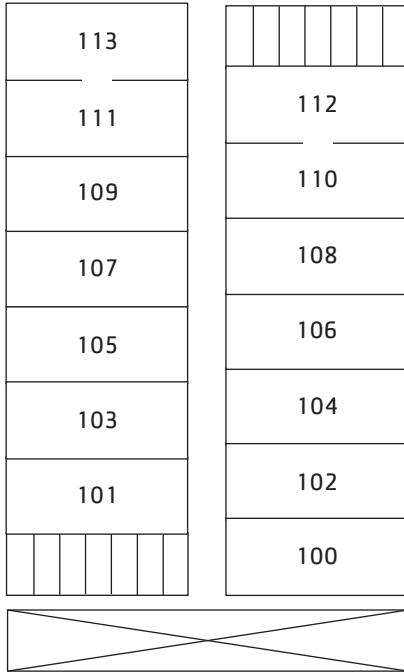

WEATHERFORD HALL FLOORPLAN

YMCA Blue Ridge Assembly

- The second floor is ground level at the front entrance, the only floor with ground level access.
- All 39 rooms are equipped with one double and one single bed and a bathroom with tile shower.
- Kitchen can be reserved in advance. It has eating/cooking supplies for up to 80 people.
- Building has heat only, handicapped parking, hallway phones, fireplace, large deck, some adjoining rooms, and drinking fountain on each floor.
- The Dining Room has one full-sized refrigerator for guest use.
- No elevator.
- Full-time staff in residence on second floor.



**1st Floor
Basement Level**

**2nd Floor
Ground Level**

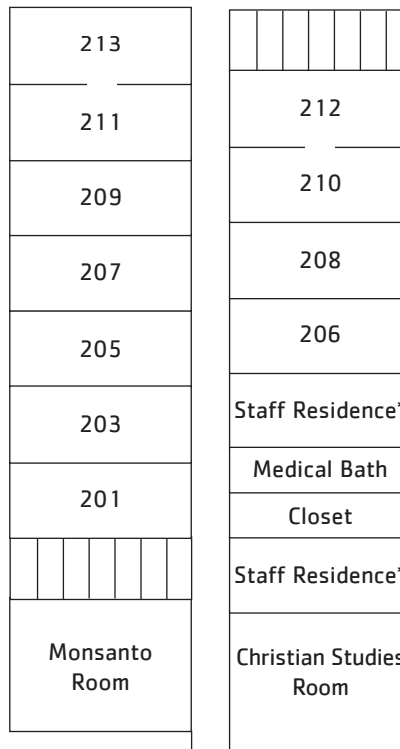

**3rd Floor
Upper Level**

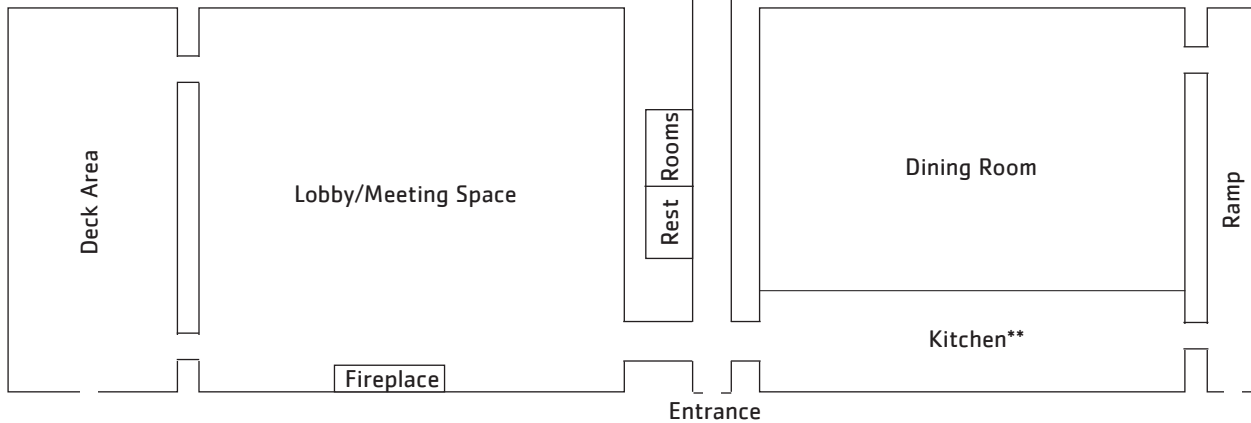
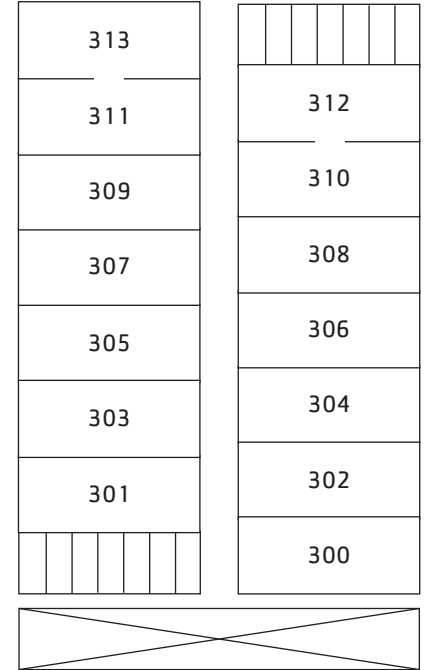

YMCA Blue Ridge Assembly (828) 669-8422

@YMCABlueRidge blueridgeassembly.org

84 Blue Ridge Circle, Black Mountain, NC 28711

*Unavailable for guest use

**Available upon advance request